

F7046

DOD 37046

REV	DESCRIPTION	DATE	BY
A	NEW DRAWING	05/17/04	H.N.
B	ADDED PAGE # 2	08/13/04	H.N.
C	CORRECTED PIN NUMBERS	01/24/13	JAG

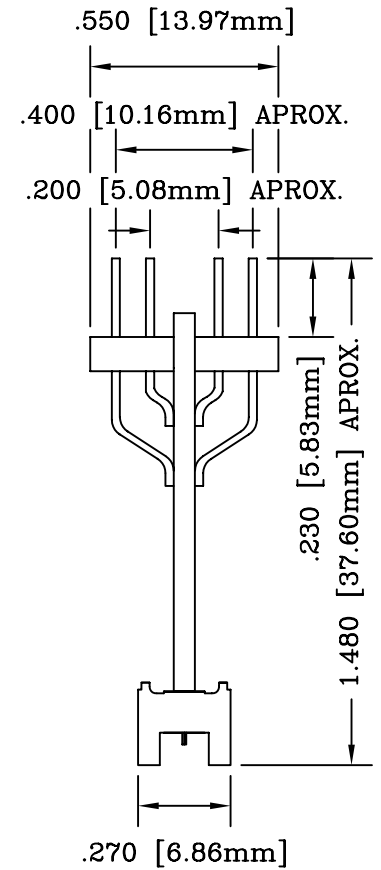
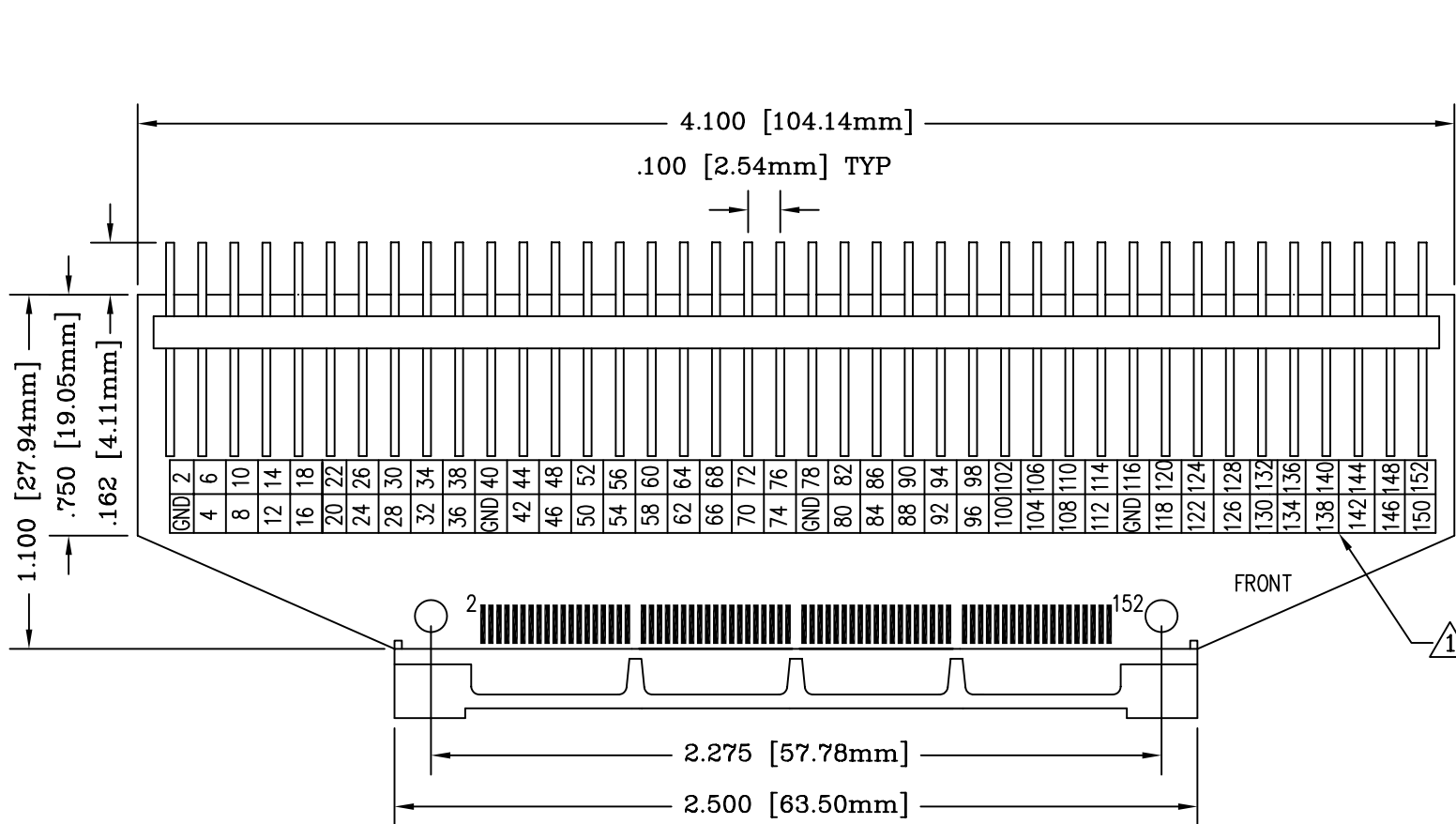

MATING CONNECTOR:	
ET PART # CON-MICTOR-MAL-152-SMT	TYCO PART # 767006-4

NOTE:

1. SILKSCREEN ON PCB IS NOT VALID FOR FEMALE VERSION.
USE PIN NUMBERS INDICATED ON THIS DRAWING FOR REFERENCE.

ALL DIMENSIONS ARE IN INCHES UNLESS OTHERWISE SPECIFIED

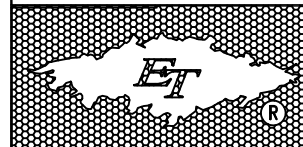

Emulation Technology, Inc.

— VLSI and SMT ADAPTERS and ACCESSORIES —

759 FLYNN ROAD
CAMARILLO, CA 93012

TEL:(805)383-8480
FAX:(805)383-8484

SHEET: 1 OF 2	DATE: 08/13/04	REVISION: C	ASSEMBLY DRAWING
CHECKED: Perry Munroe	DRAWN: Huy Nguyen	ITEM: MIC-152-BREAKFEM	DESCRIPTION: MIC-152-BREAKOUT-FEMALE
Scale 2:1	DO NOT SCALE DRAWING		

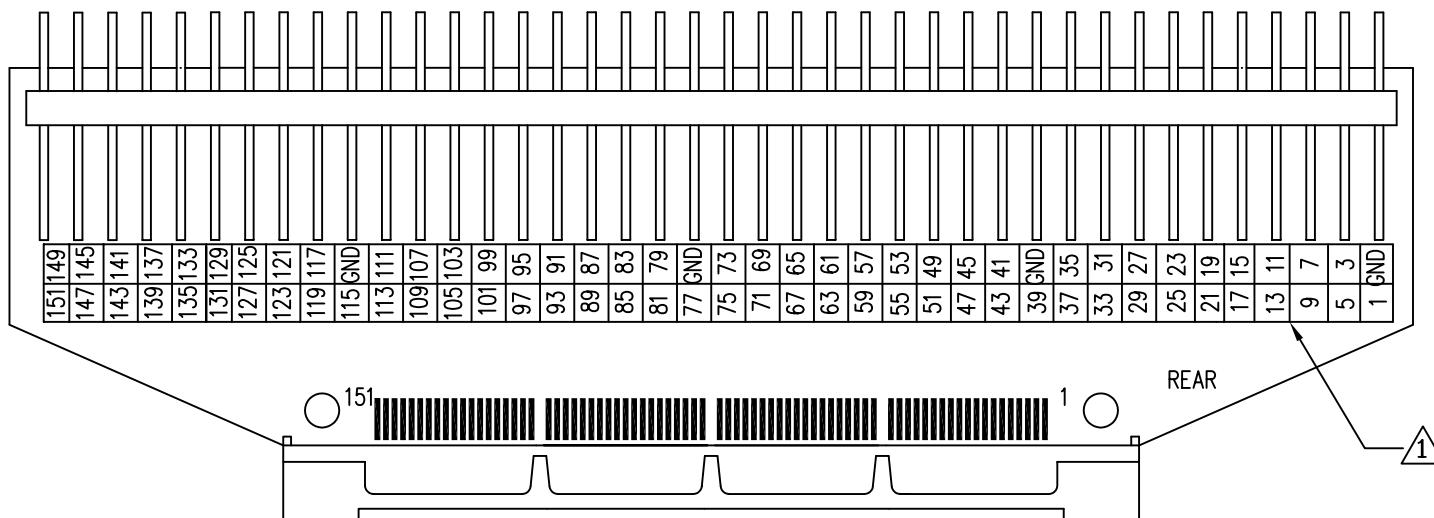

MATING CONNECTOR:

ET PART # CON-MICTOR-MAL-152-SMT	TYCO PART # 767006-4
-------------------------------------	-------------------------

ALL DIMENSIONS ARE IN INCHES UNLESS OTHERWISE SPECIFIED

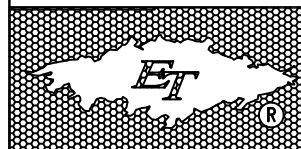

Emulation Technology, Inc.

— VLSI and SMT ADAPTERS and ACCESSORIES —

759 FLYNN ROAD
CAMARILLO, CA 93012

TEL:(805)383-8480
FAX:(805)383-8484

SHEET: 2 OF 2	DATE: 08/13/04	REVISION: C	ASSEMBLY DRAWING
CHECKED: Perry Munroe	DRAWN: Huy Nguyen	☉ ◁	ITEM: MIC-152-BREAKFEM
Scale 2:1	DO NOT SCALE DRAWING	DESCRIPTION: MIC-152-BREAKOUT-FEMALE	