

<b>.100</b>	<b>Socket</b>	<b>Single Row – Screw Machine Contacts for .025”</b>	<b>Right Angle</b>	<b>Thru Hole</b>
-------------	---------------	--	--------------------	------------------

.100” Center – Single Row Right Angle – accepting .025 inch Square Pin – Screw Machine Socket

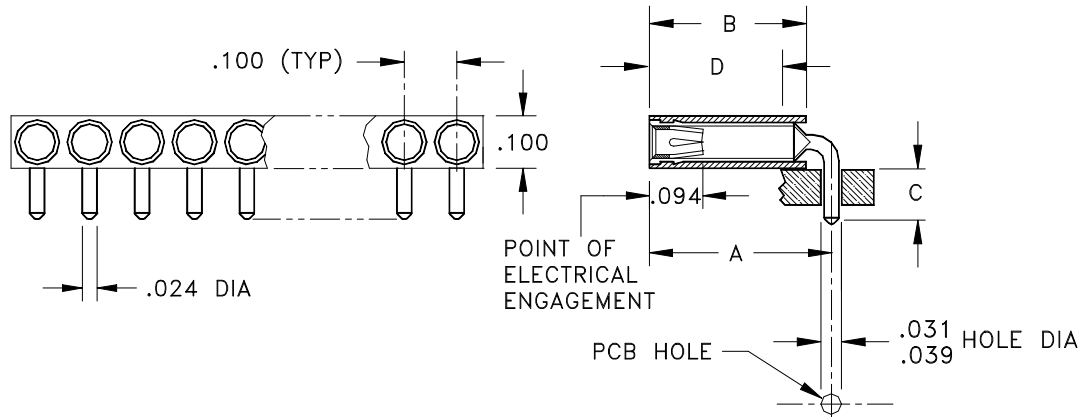

Base Part Number	A		B		C		D		E		Plating Options	Number of Positions
	mm	Inch	mm	Inch	mm	Inch	mm	Inch	mm	Inch		
<b>1163R</b>	8.31	0.327	6.86	0.270	3.20	0.126	5.79	0.228			G2LF: TLF	1-40

Technical Notes	
<b>Contact Material:</b>	Shell: Phosphor Bronze, Contact Clip [#47]: 6 Finger, BeCu
<b>Insulation Material:</b>	Glass Filled Nylon 46 - UL 94V-0 rated - Black (std)
<b>Temperature Range:</b>	-65°C to 250°C
<b>Insulation Resistance:</b>	5000 MegOhm @ 500VDC
<b>Current Rating:</b>	3 amps continuous @ 100 VDC/contact
<b>Max Processing Temp:</b>	250°C for 60 seconds
<b>Plastic:</b>	High Temperature Plastic
<b>INTERCONNECT SYSTEMS INC.</b>	
741 Flynn Road, Camarillo, Ca 93012 · (805) 482-2870 · fax (805) 482-8470 · e-mail: <a href="mailto:info@isipkg.com">info@isipkg.com</a>	