

2mm	Socket	Double Row - Screw Machine Socket	Straight	Thru Hole
-----	--------	-----------------------------------	----------	-----------

2mm Center - Double Row Straight - using Screw Machine Contacts

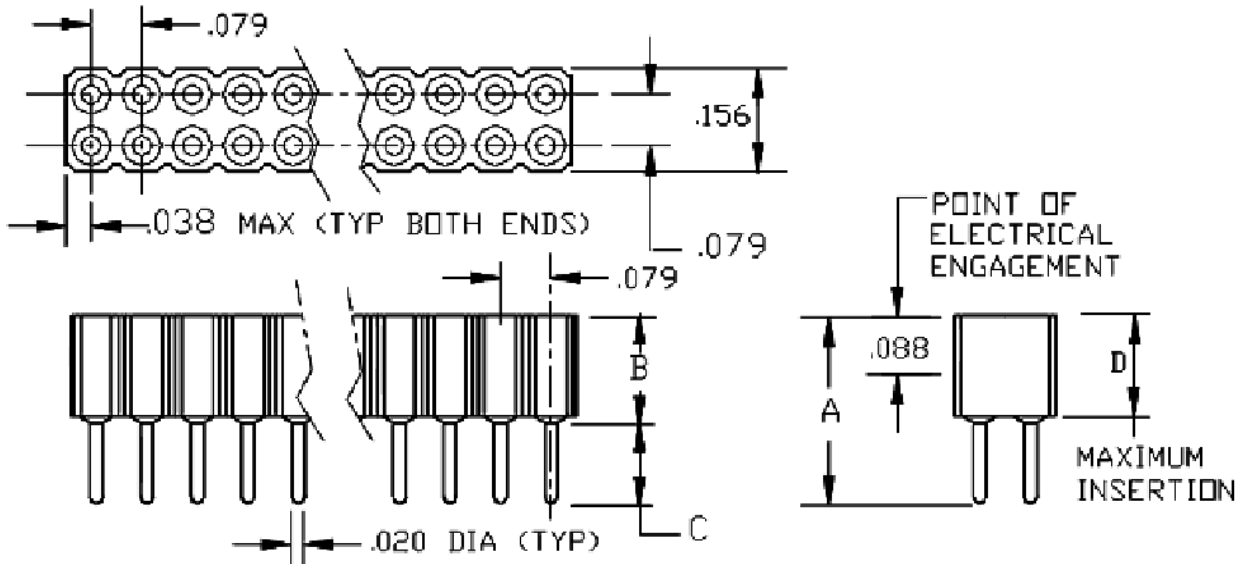

PART NUMBER	PIN		(Typical) INSERTION FORCE	(Typical) EXTRACTION FORCE
1250	.020" Square		7.8oz (220grams)	4.9oz (139 grams)
1250	.020" Round		5.5oz (157grams)	3.3oz (93 grams)
1251	.020" Square		2.6oz (73 grams)	1.8oz (51 grams)
1251	.020" Round		1.8oz (52grams)	1.1oz (32 grams)
1252	.020" Square		2.6oz (73 grams)	1.8oz (51 grams)
1252	.020" Round		1.8oz (52grams)	1.1oz (32 grams)
1253	.020" Square		7.8oz (220grams)	4.9oz (139 grams)
1253	.020" Round		5.5oz (157grams)	3.3oz (93 grams)
1254	.020" Square		8.6oz (244 grams)	5.4oz (152 grams)
1254	.020" Round		5.7oz (161grams)	3.6oz (102 grams)

Base Part Number	A		B		C		D		E		Plating Options	Number of Postions
	mm	Inch	mm	Inch	mm	Inch	mm	Inch	mm	Inch		
1252	5.72	0.225	4.19	0.165	1.52	0.060	3.81	0.150			G2LF: TLF	4-100
1251	6.73	0.265	4.19	0.165	2.54	0.100	3.81	0.150			G2LF: TLF	4-100
1250	7.37	0.290	4.19	0.165	3.18	0.125	3.81	0.150			G2LF: TLF	4-100
1253	9.02	0.355	4.44	0.175	4.57	0.180	3.81	0.150			G2LF: TLF	4-100
1254	13.08	0.515	4.44	0.175	8.71	0.343	3.81	0.150			G2LF: TLF	4-100

<b>Technical Notes</b>	
<b>Contact Material:</b>	Shell: Phosphor Bronz - Contact Clip: 6 finger BeCu [#32 -43 - Di-172]
<b>Insulation Material:</b>	Glass Filled Nylon 46 - UL 94V-0 rated - Black (std)
<b>Heat Deflection:</b>	260°C @ 264 PSI per ASTM D648
<b>Insulation Resistance:</b>	5000 MegOhm @ 500VDC
<b>Current Rating:</b>	1 amps continuous @ 100 VDC/contact
<b>Max Processing Temp:</b>	250°C for 60 seconds
<b>Insertion Force:</b>	See bottom of drawing above
<b>Extraction Force:</b>	See bottom of drawing above
<b>Plastic:</b>	High Temperature Plastic
<p><b><i>INTERCONNECT SYSTEMS INC.</i></b>            741 Flynn Road, Camarillo, Ca 93012 · (805) 482-2870 · fax (805) 482-8470 · e-mail: <a href="mailto:info@isipkg.com">info@isipkg.com</a></p>	