

REV	DESCRIPTION	DATE	BY
A	NEW DRAWING	12/17/14	JAG

SKT4118

DEVICE SIDE

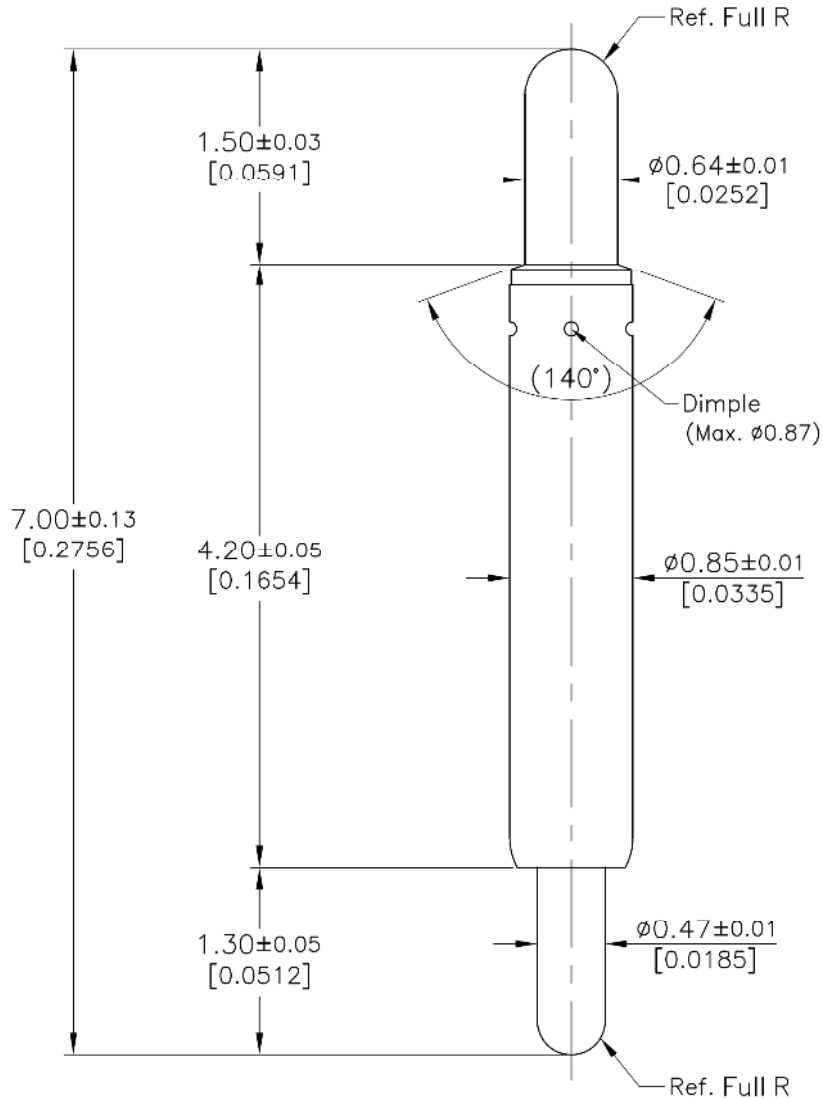

BOARD SIDE

Pointing Accuracy: ± 0.065 mm

Note: It is highly recommended to consider this Pointing Accuracy in the housing design to avoid SHORT issues or abnormal mechanical operation.

Spring Force: ± 20%

STATE	TRAVEL	SPRING FORCE
Initial Travel	--	8.2g (0.289oz)
Recommended Travel	0.75mm (0.0295)	37.0g (1.305oz)
Full Travel	1.00mm (0.0394)	46.6g (1.644oz)

PART	MATERIAL	FINISH
Terminal (Device Side)	Hardened Beryllium Copper	Gold Plated
Plunger (Board Side)	Hardened Beryllium Copper	Gold Plated
Barrel	Phosphor Bronze	Gold Plated
Spring	Stainless Steel	Gold Plated
Ball	Hardened Steel	Gold Plated

ALL DIMENSIONS ARE IN MILLIMETERS UNLESS OTHERWISE SPECIFIED



EMULATION TECHNOLOGY, INC.

— VLSI and SMT ADAPTERS and ACCESSORIES —

759 FLYNN ROAD
CAMARILLO, CA 93012

TEL: (805) 383-8480
FAX: (805) 383-8484

SHEET: 1 OF 1	DATE: 12/17/14	REVISION: A	ASSEMBLY DRAWING
CHECKED:	PREPARED BY: J. GELACIO	ITEM: POGO-PIN-7.00-4	
DO NOT SCALE DRAWING			DESCRIPTION: POGO-PIN-7.00-4