

REV	DESCRIPTION	DATE	BY
A	NEW DRAWING	01/29/13	JAG

SKT3872

DEVICE SIDE

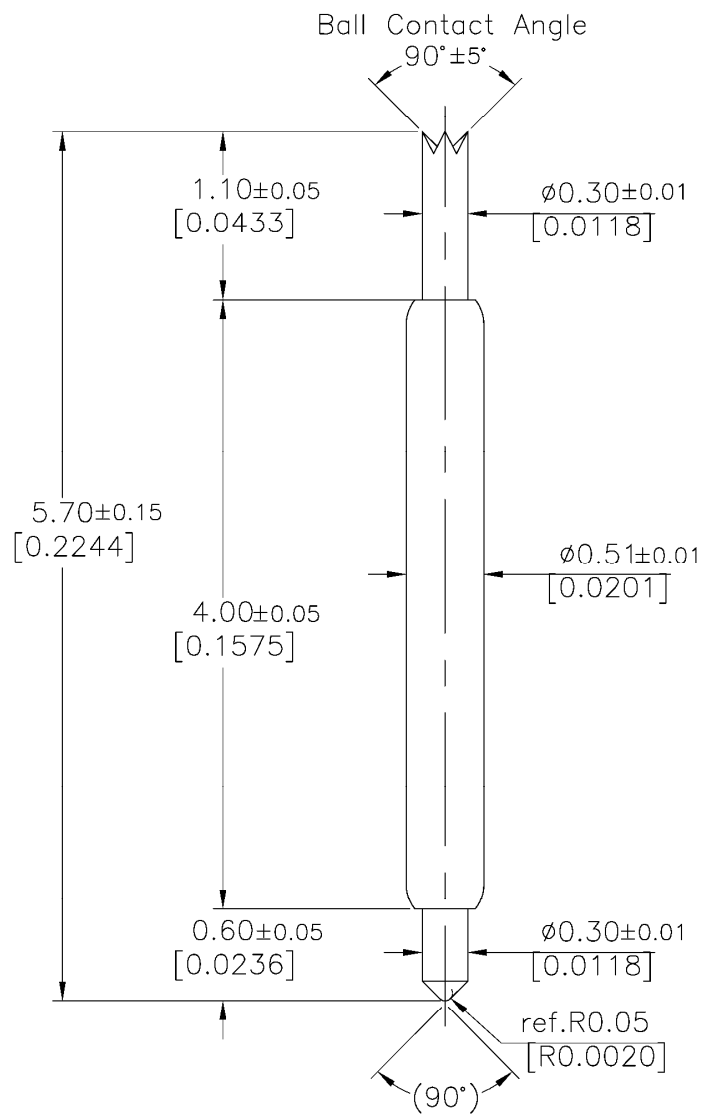

Pointing Accuracy: ± 0.05 mm  
Spring Force: ± 20%

STATE	TRAVEL	SPRING FORCE
Initial Travel	--	5.3 g (0.185 oz)
Recommended Travel	0.65 mm (0.0256)	23.0 g (0.811 oz)
Full Travel	1.00 mm (0.0394)	32.9 g (1.161 oz)

PART	MATERIAL	FINISH
Plunger (Device Side)	Hardened Beryllium Copper	Gold Plated
Plunger (Board Side)	Hardened Beryllium Copper	Gold Plated
Barrel	Phosphor Bronze	Gold Plated
Spring	Stainless Steel	Gold Plated

DIMENSIONS ARE IN MM UNLESS OTHERWISE SPECIFIED  
SPECIFIED TOLERANCES ARE:  
X.X ±0.100MM ANGULAR: X.X° ±1.0°  
X.XX ±0.050MM X.XX° ±0.5°  
X.XXX ±0.025MM

BOARD SIDE

ALL DIMENSIONS ARE IN MILLIMETERS UNLESS OTHERWISE SPECIFIED

	<b>EMULATION TECHNOLOGY, INC.</b>	
	VLSI and SMT ADAPTERS and ACCESSORIES	
759 FLYNN ROAD CAMARILLO, CA 93012		TEL: (805) 383-8480 FAX: (805) 383-8484
SHEET: 1 OF 1	DATE: 01/29/13	REVISION: A
CHECKED:		ASSEMBLY DRAWING
PREPARED BY: J. GELACIO		ITEM: POGO-PIN-5.70-B
DO NOT SCALE DRAWING		DESCRIPTION: POGO-PIN-5.70-B