

REV	DESCRIPTION	DATE	BY
A	NEW DRAWING	01/31/12	JAG

SKT3740

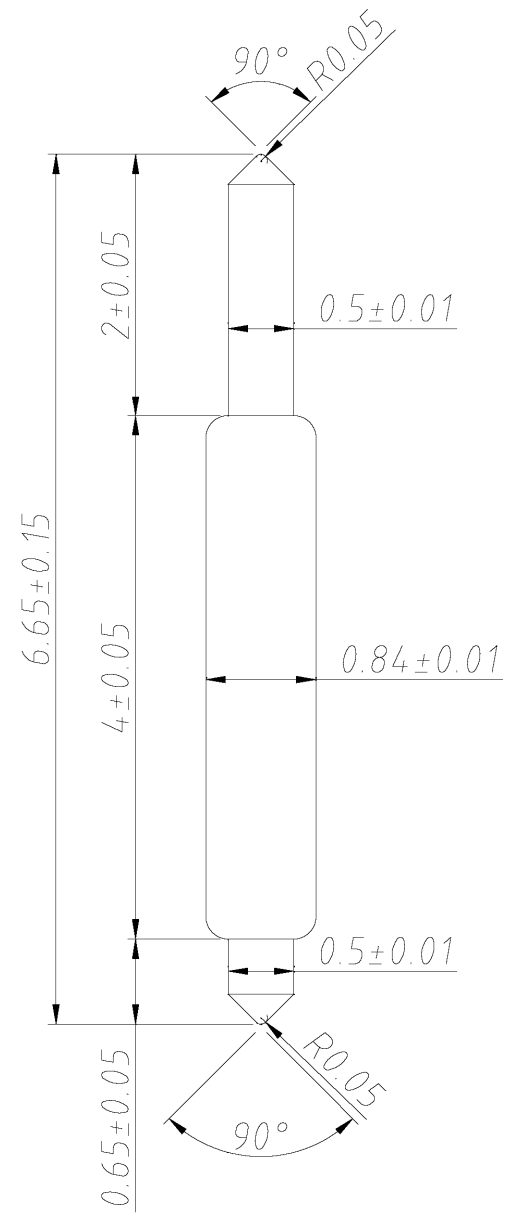

STATE	TRAVEL (mm)	SPRING FORCE (g)
Initial Travel	--	7.1
Recommended Travel	0.80	30.0
Full Travel	1.05	37.5

Spring Force: ± 20%

Pointing Accuracy: ± 0.05 mm

PART	MATERIAL	FINISH
Spring	Music Wire	Gold Plated
Barrel	Brass	Gold Plated
Top Plunger	Hardened Beryllium Copper	Gold Plated
Bottom Plunger	Hardened Beryllium Copper	Gold Plated

DIMENSIONS ARE IN MM UNLESS OTHERWISE SPECIFIED TOLERANCES ARE:  
 X.X ±0.100MM ANGULAR: X.X° ±1.0°  
 X.XX ±0.050MM X.XX° ±0.5°  
 X.XXX ±0.025MM

ALL DIMENSIONS ARE IN MILLIMETERS UNLESS OTHERWISE SPECIFIED

	<b>EMULATION TECHNOLOGY, INC.</b>	
	VLSI and SMT ADAPTERS and ACCESSORIES	
759 FLYNN ROAD CAMARILLO, CA 93012		TEL: (805) 383-8480 FAX: (805) 383-8484
SHEET: 1 OF 1	DATE: 01/31/12	REVISION: A
ASSEMBLY DRAWING		
CHECKED:	PREPARED BY: J. GELACIO	ITEM: POGO-PIN-6.65-1
DO NOT SCALE DRAWING		DESCRIPTION: POGO-PIN-6.65-1