

REV	DESCRIPTION	DATE	BY
A	NEW DRAWING	02/10/11	JAG

SKT3590

CUTTER ANGLE

[DEVICE SIDE]

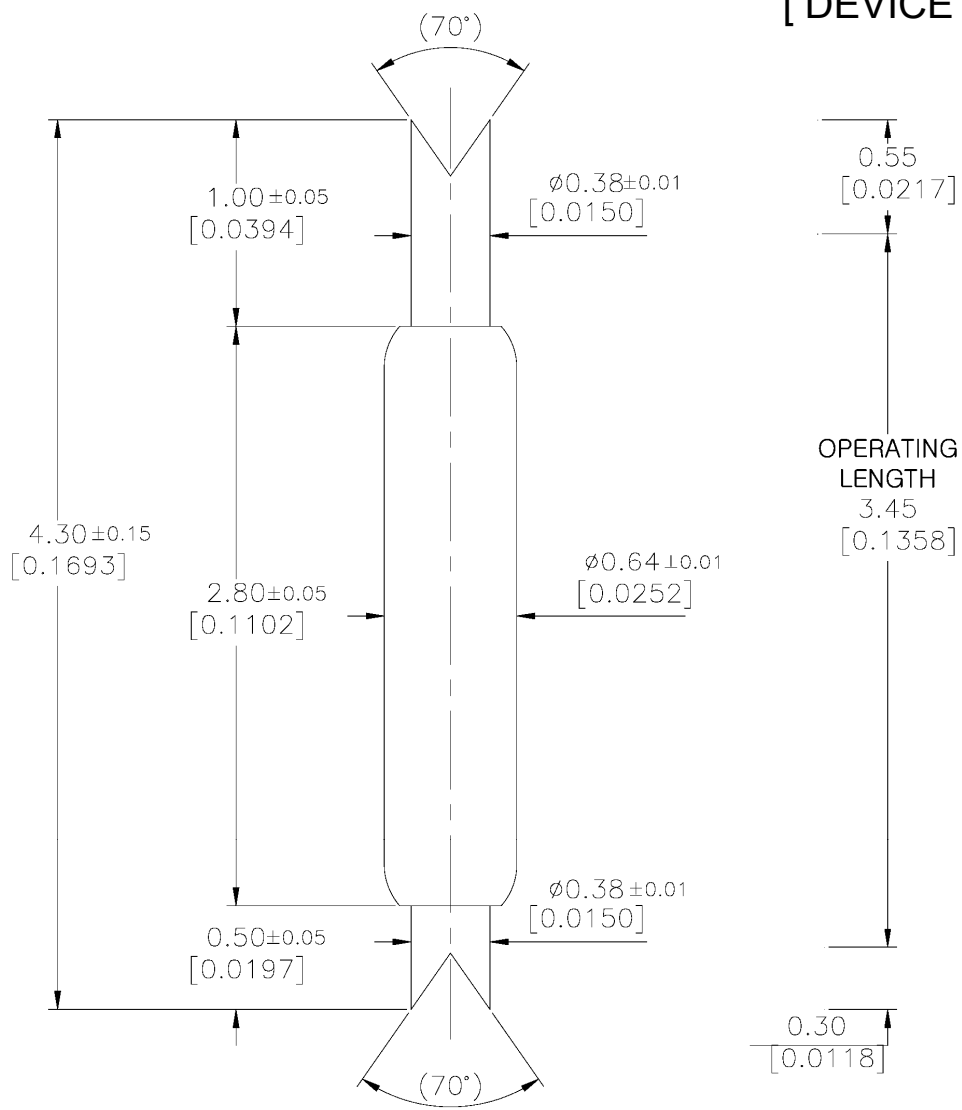

Pointing Accuracy: ± 0.70 mm

Spring Force [±20%]

- 8.6g (0.303oz) at initial travel
- * 29.5g (1.041oz) at 0.85mm (0.0335) recommended travel
- * 32.0g (1.129oz) at 0.95mm (0.0374) full travel

Material & Finish

Plunger (Device)	Hardened Beryllium Copper	/ Gold Plated
Plunger (Board)	Hardened Beryllium Copper	/ Gold Plated
Barrel	Phosphor Bronze	/ Gold Plated
Spring	Stainless Steel	/ Gold Plated

*** Notice for Socket Designs:**
It is very important to verify the actual working travel when this probe is set in a socket due to the 0.10mm difference between *recommended* and *full* travel. If the actual working travel is over 0.95mm, the device, spring, plunger, and/or PCB pad will be damaged.

DIMENSIONS ARE IN MM UNLESS OTHERWISE SPECIFIED TOLERANCES ARE:	
X.X ±0.100MM	ANGULAR: X.X° ±1.0°
X.XX ±0.050MM	X.XX° ±0.5°
X.XXX ±0.025MM	

ALL DIMENSIONS ARE IN MILLIMETERS UNLESS OTHERWISE SPECIFIED

	EMULATION TECHNOLOGY, INC. VLSI and SMT ADAPTERS and ACCESSORIES	
	759 FLYNN ROAD CAMARILLO, CA 93012	TEL: (805) 383-8480 FAX: (805) 383-8484
SHEET: 1 OF 1	DATE: 02/10/11	REVISION: A
CHECKED:		PREPARED BY: J. GELACIO
DO NOT SCALE DRAWING		ITEM: POGO-PIN-4.30-3 DESCRIPTION: POGO-PIN-4.30-3

CUTTER ANGLE

[BOARD SIDE]