

REV	DESCRIPTION	DATE	BY
A	NEW DRAWING	11/02/09	JAG

SKT3355

TOP

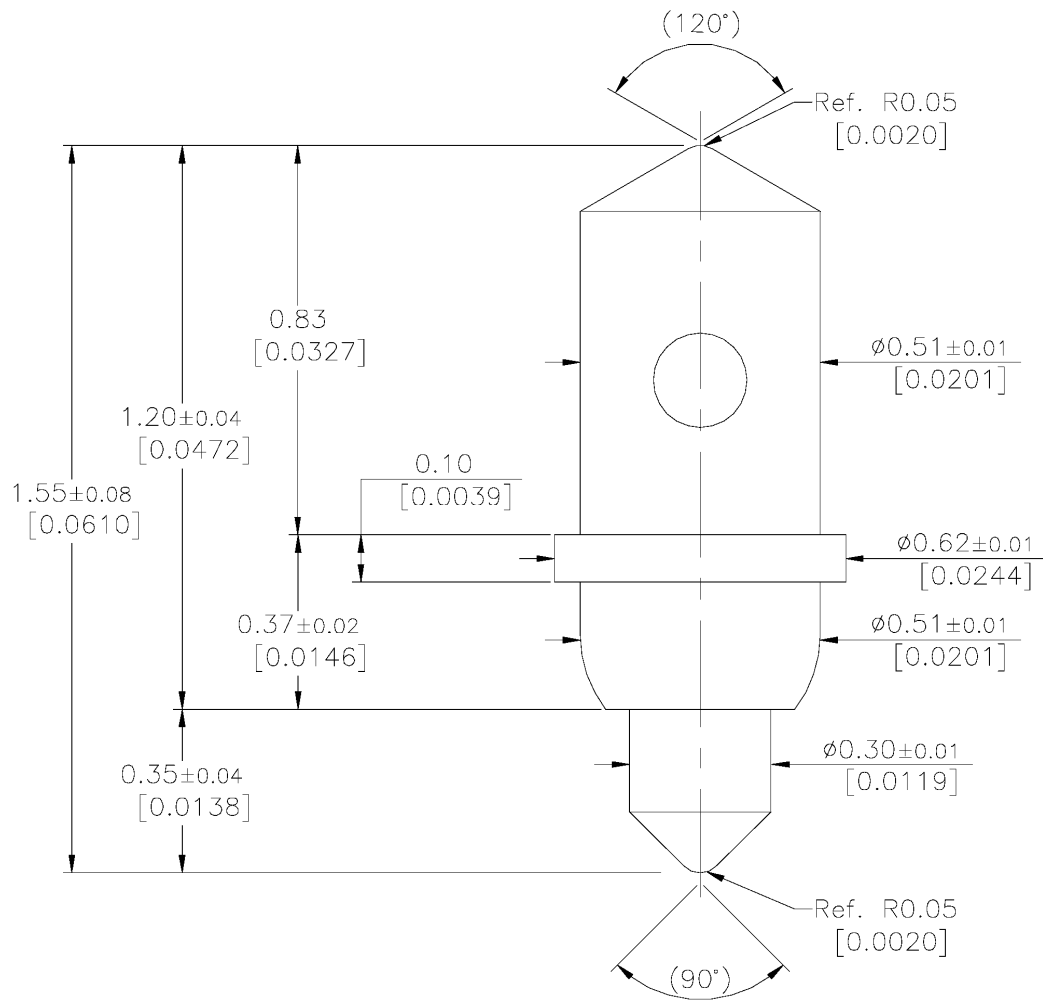

BOTTOM

Pointing accuracy : ± 0.05 mm

Spring force[$\pm 20\%$]

10.5g(0.370oz) at initial travel

20.0g(0.705oz) at 0.23mm(0.0091) recommended travel

24.0g(0.847oz) at 0.31mm(0.0122) full travel

Material & Finish

Plunger Hardened Beryllium copper / Gold Plated

Barrel Hardened Beryllium copper / Gold Plated

Spring Music Wire / Gold Plated

NOTICE: Must be reflected in a socket design.

When this probe is set in a socket, it is very important to verify the actual working travel due to the difference of 0.08mm between the recommended and full travel. In case the actual working travel is over 0.23mm, the device, spring, plunger, and/or PCB pad will be damaged.

ALL DIMENSIONS ARE IN MILLIMETERS UNLESS OTHERWISE SPECIFIED



EMULATION TECHNOLOGY, INC.

VLSI and SMT ADAPTERS and ACCESSORIES

759 FLYNN ROAD
CAMARILLO, CA 93012

TEL: (805) 383-8480
FAX: (805) 383-8484

SHEET:
1 OF 1

DATE:
11/02/09

REVISION:
A

ASSEMBLY DRAWING

CHECKED:

PREPARED BY:
J. GELACIO

ITEM:

POGO-PIN-1.55-1

DESCRIPTION:

POGO-PIN-1.55-1

DO NOT SCALE DRAWING

Unit : Millimeter[inch]